

The main entrance of the neighborhood and the pedestrian path that leads to unused dead-end alleys

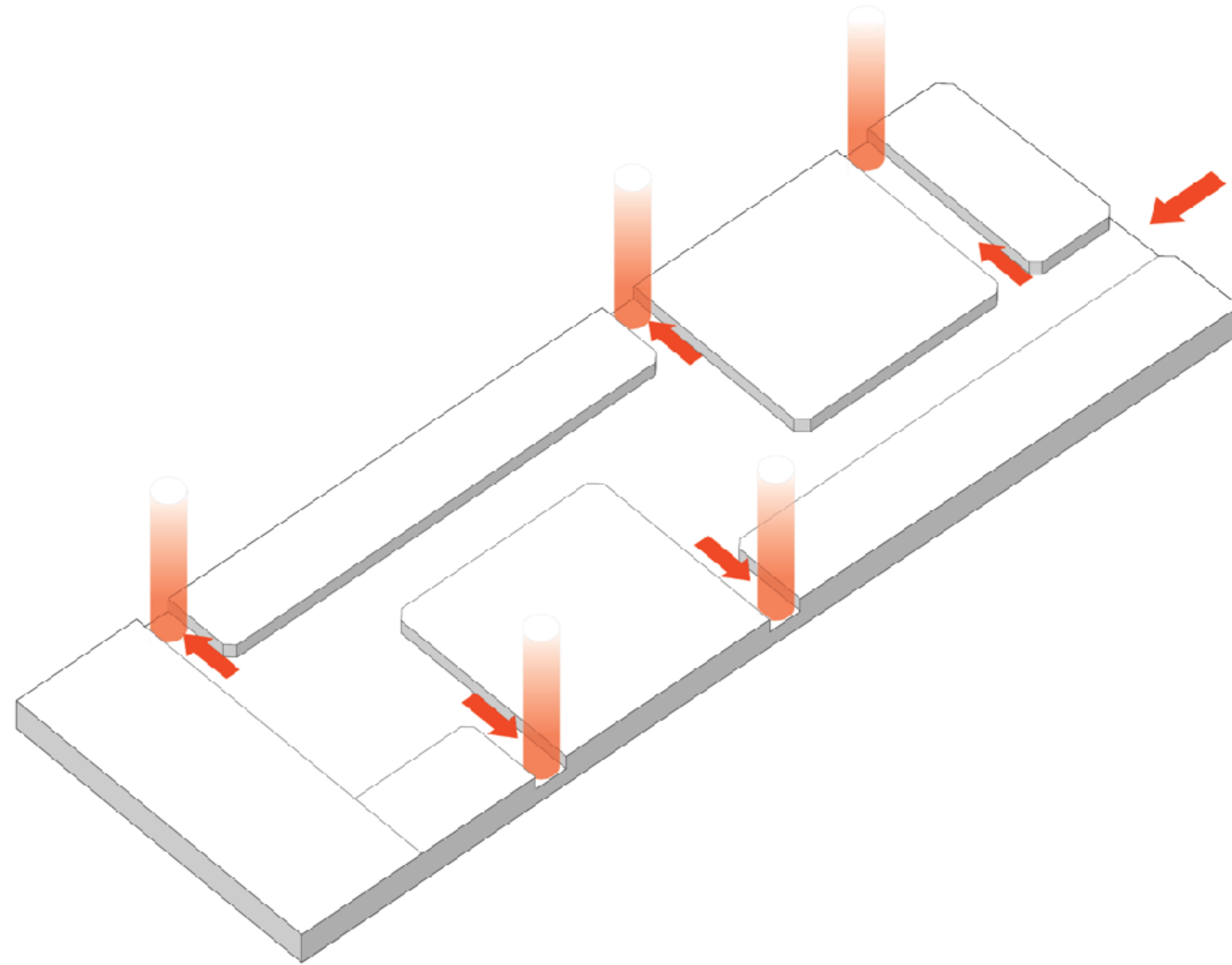

Creating communal spaces and stopping points with vegetation cover to give identity to the unused dead-end alleys

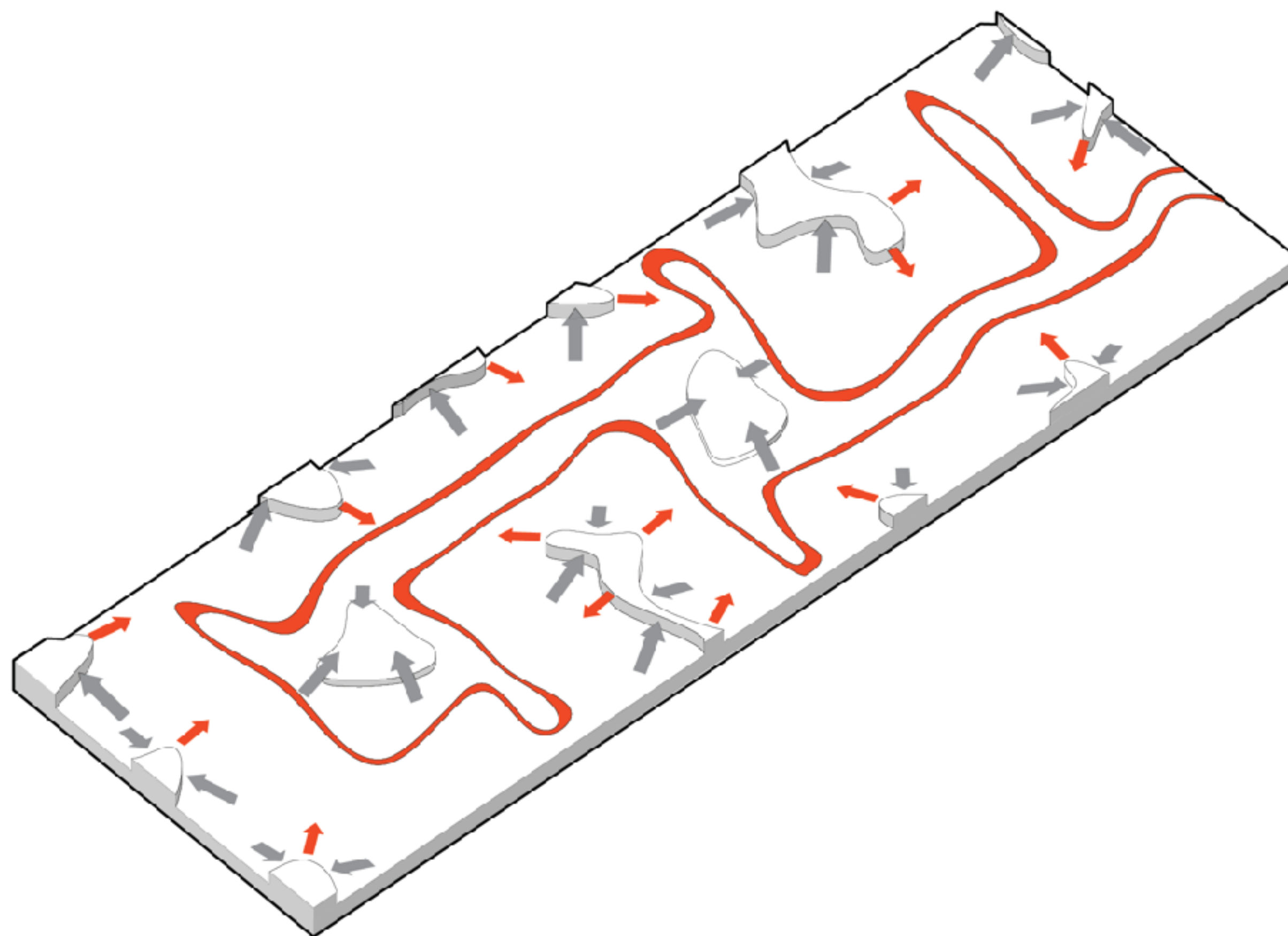

Altering the topography of the neighborhood by incorporating hills with varying elevations to create scenic views and shape diverse clusters of villas

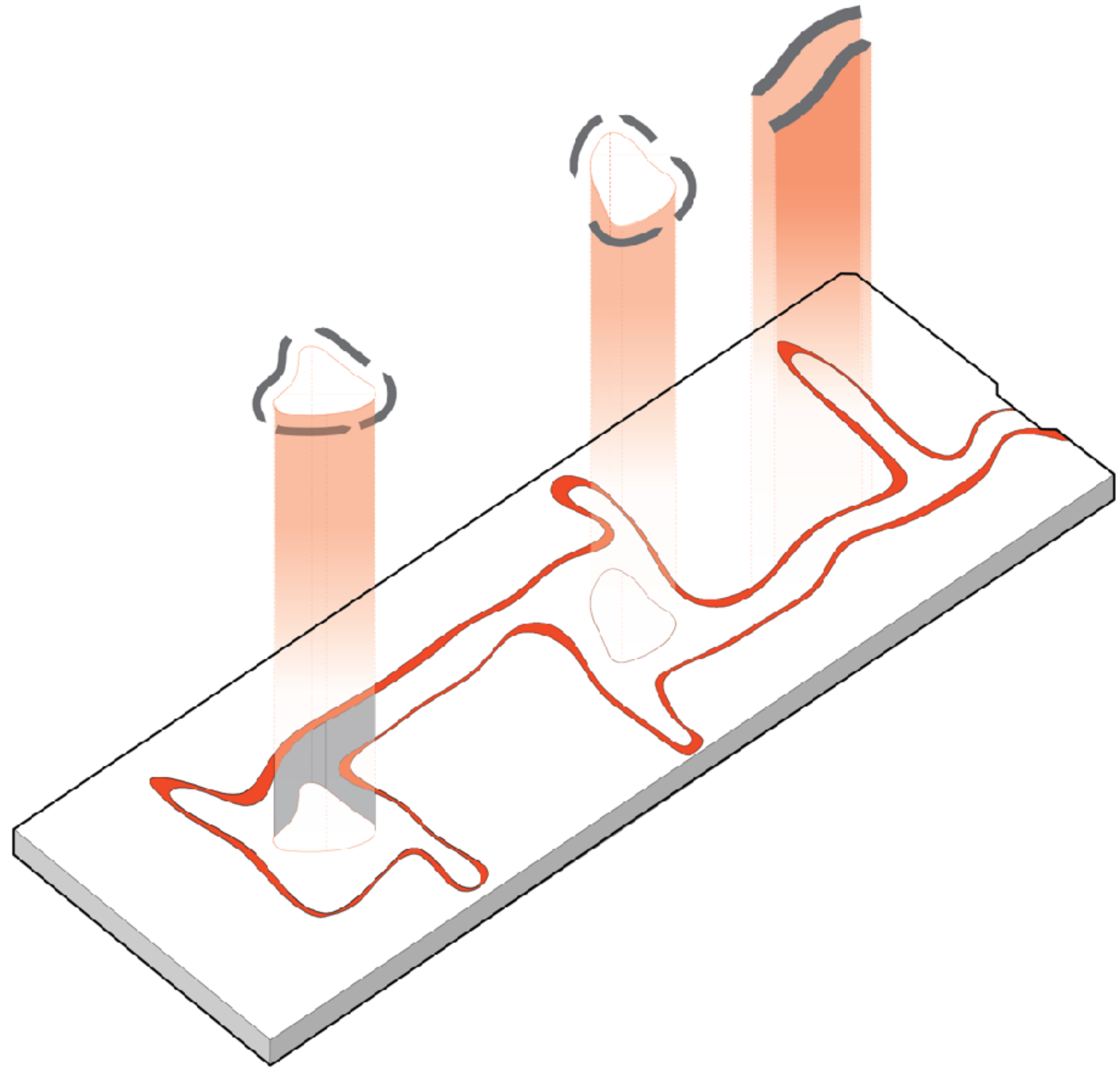

Modifying the street layout and creating a flat pedestrian pathway alongside it, as well as forming two squares to create divided spaces

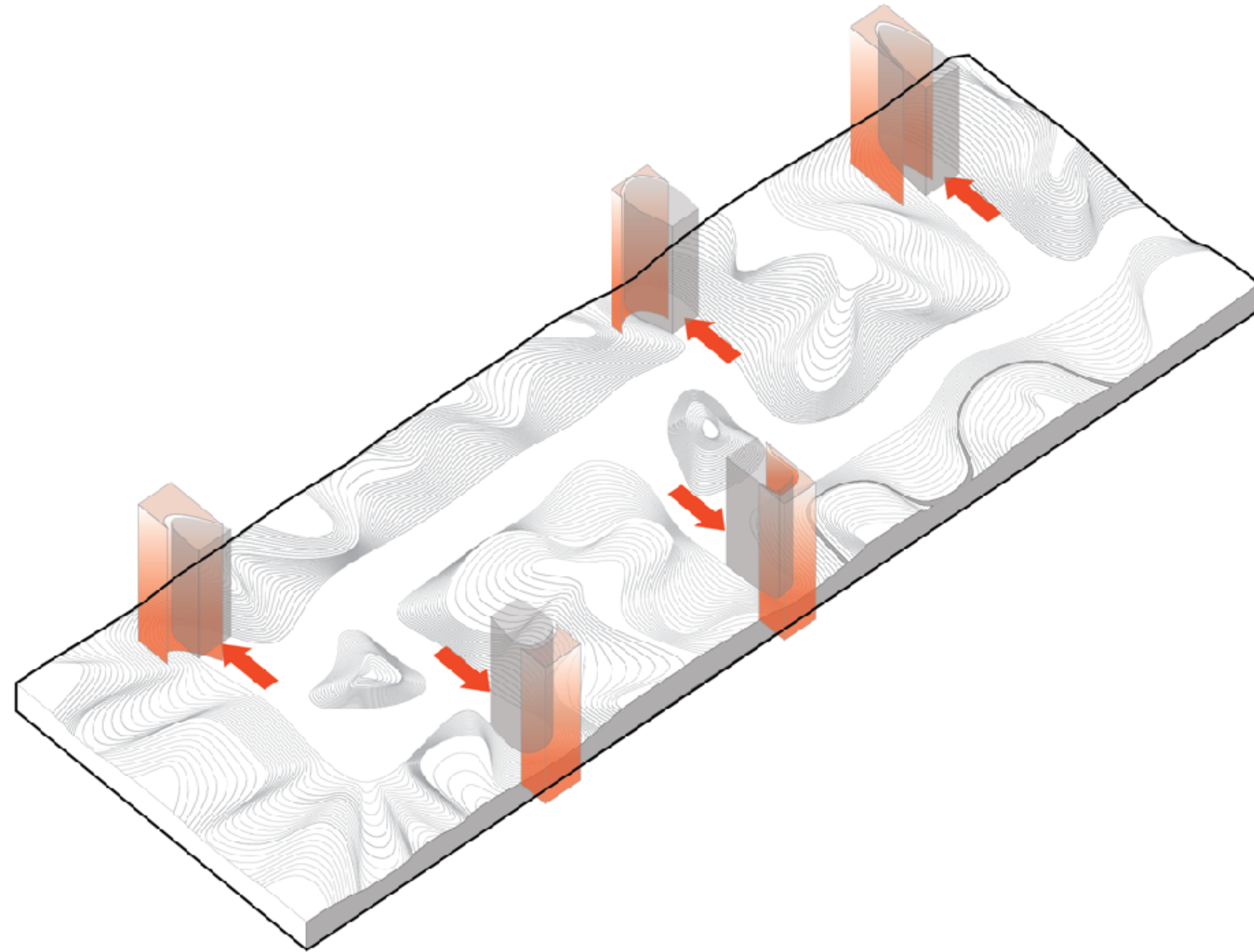

Formation of terraced topography along with peaks of hills and squares, and designing dead-end alleys that resemble the street forms

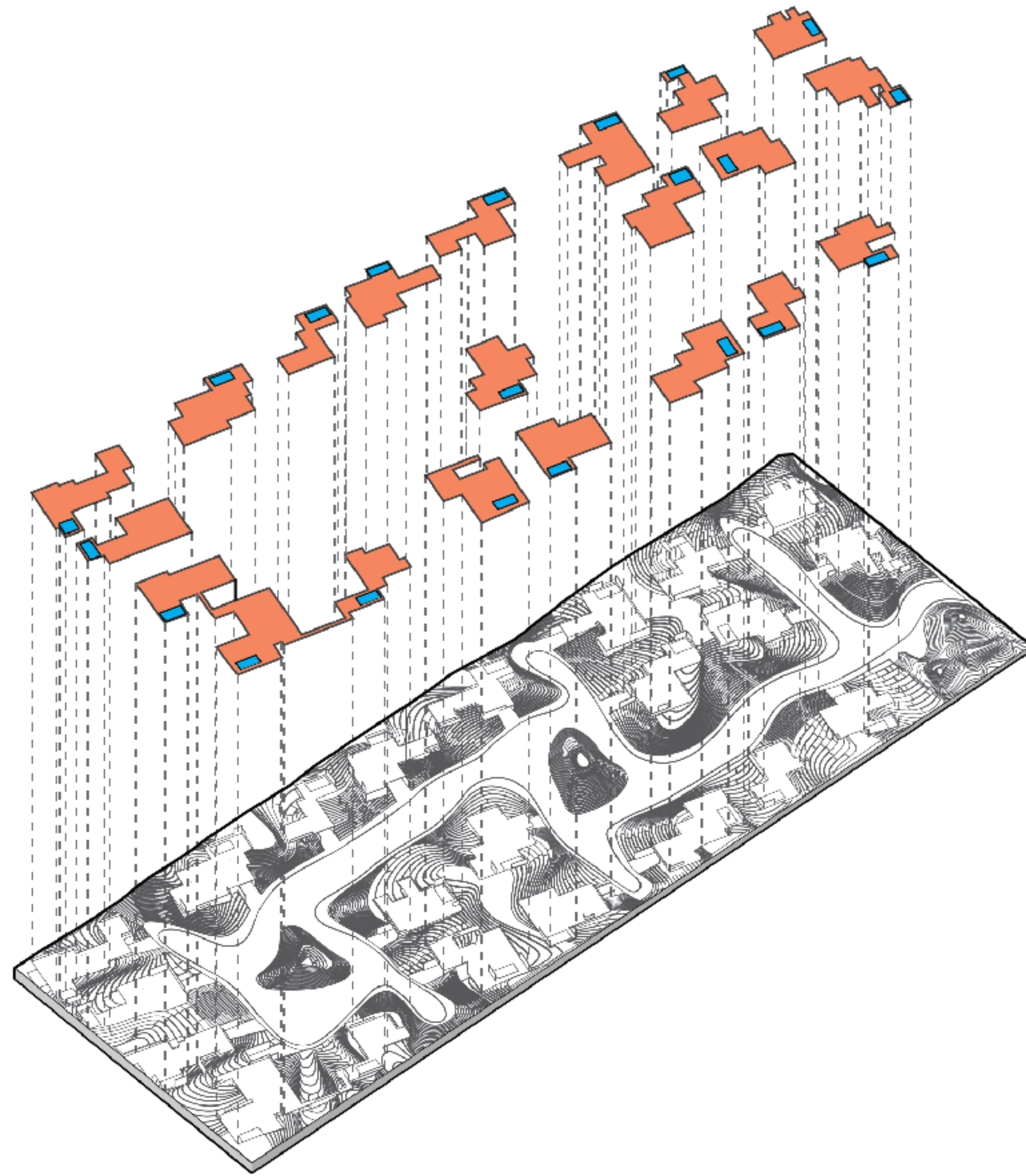

Creating flat courtyards alongside existing stairway spaces at the boundary of each villa on the site, where the villa and swimming pool are accommodated

Diagram

VILLA DESIGN DIAGRAM



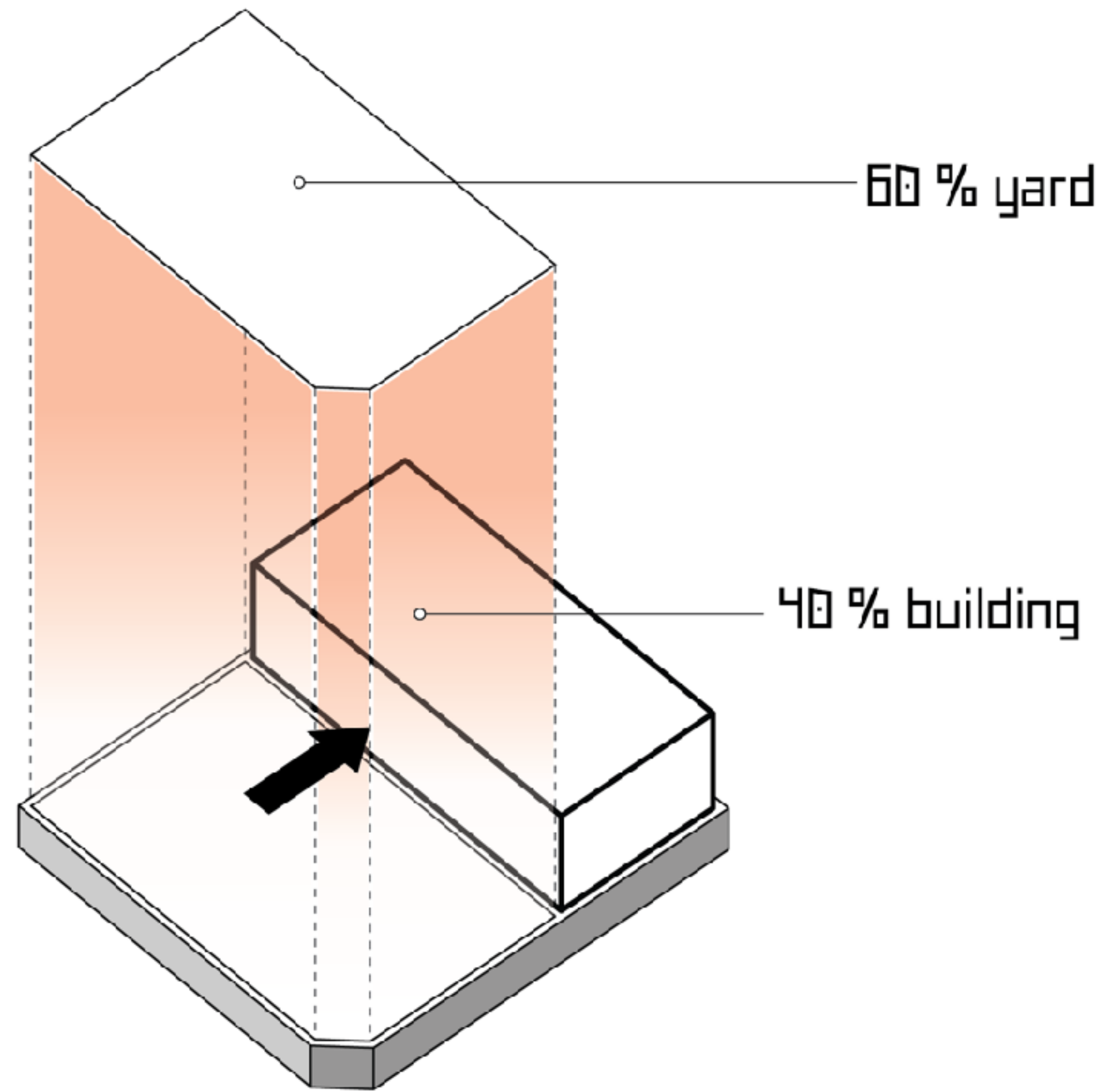

Simple and typical villa in the desired land

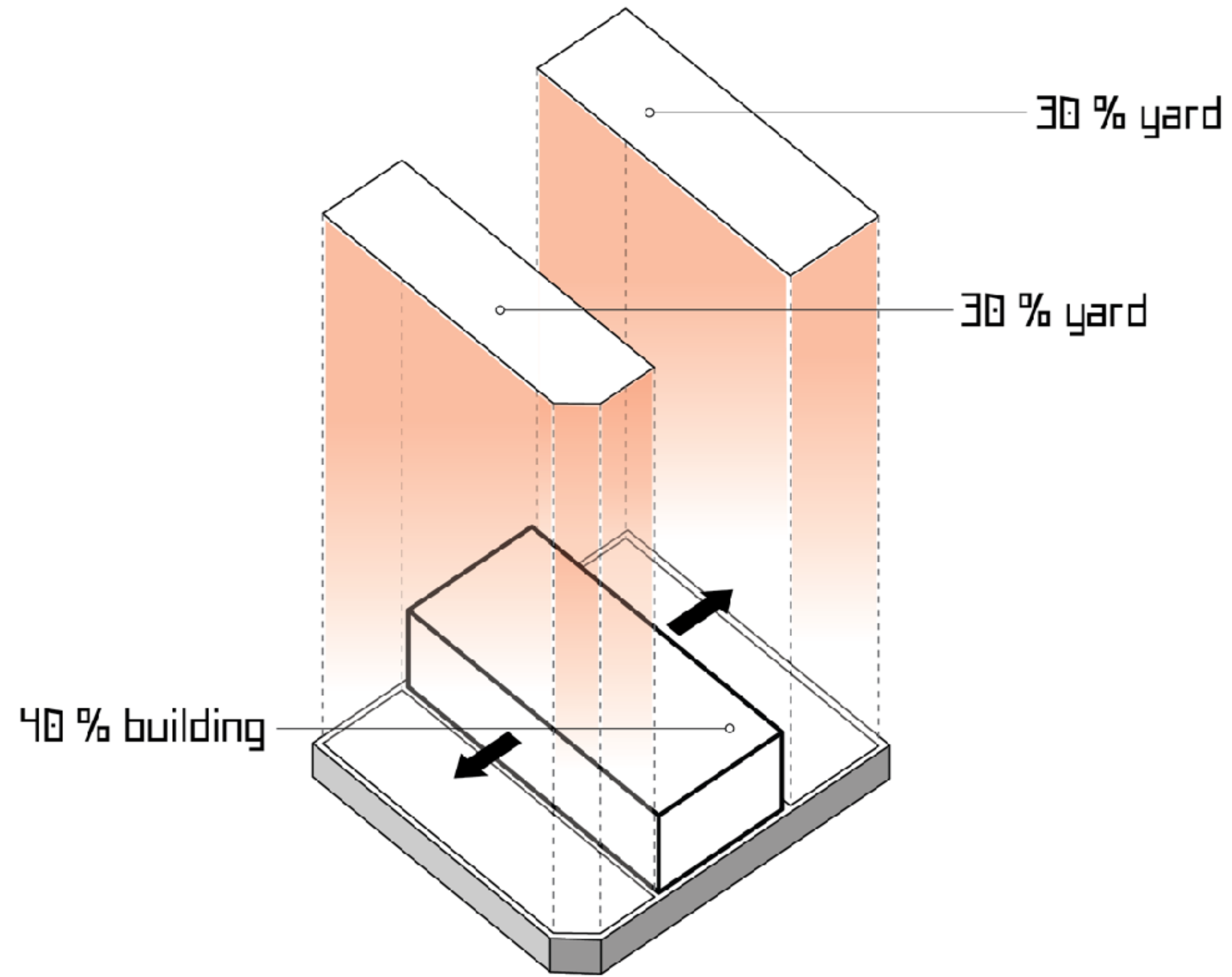

A villa situated in the middle of the land
with the courtyard divided into two sections

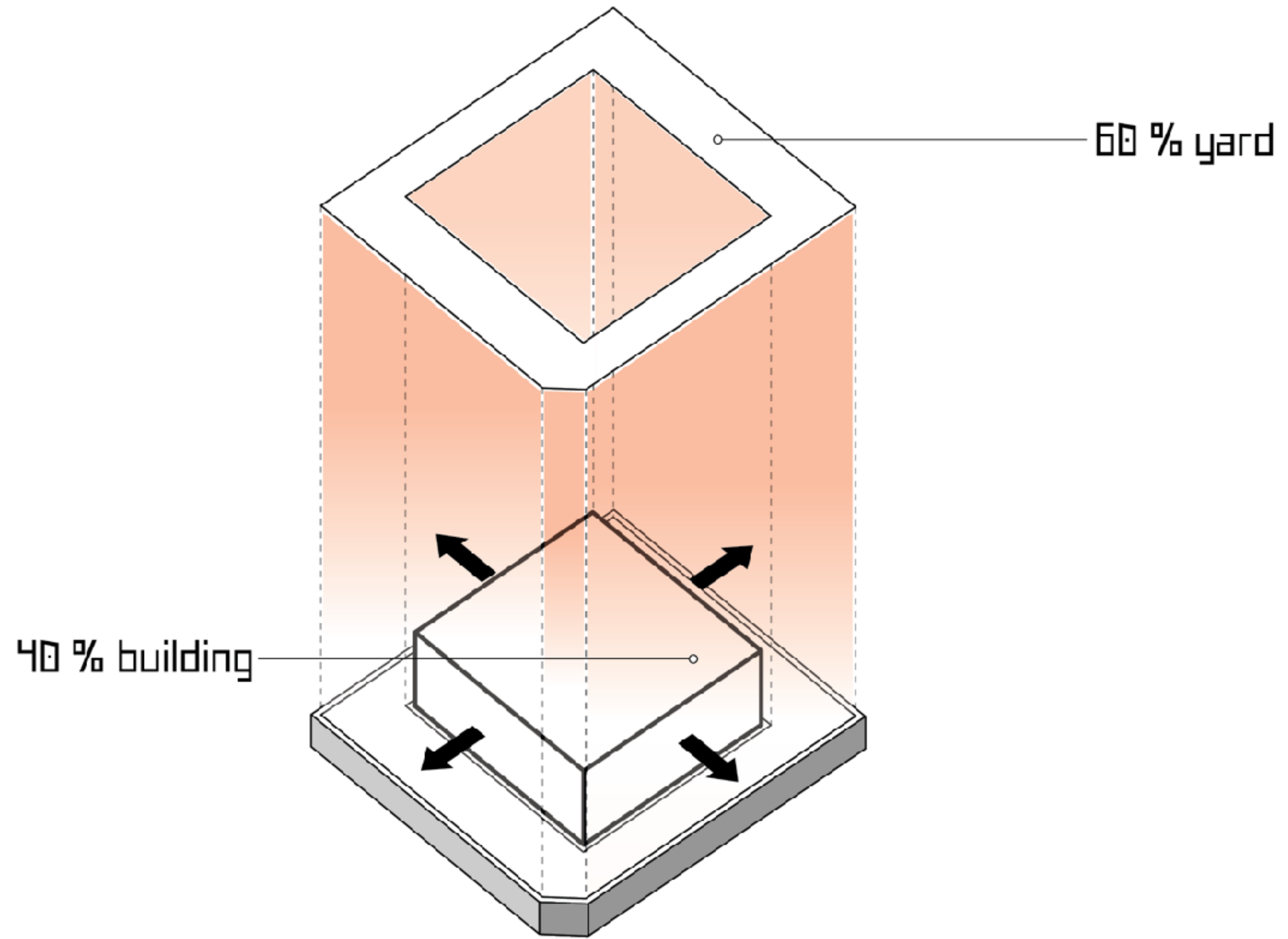

The villa is positioned in the middle of the land with the courtyard designed to surround the villa

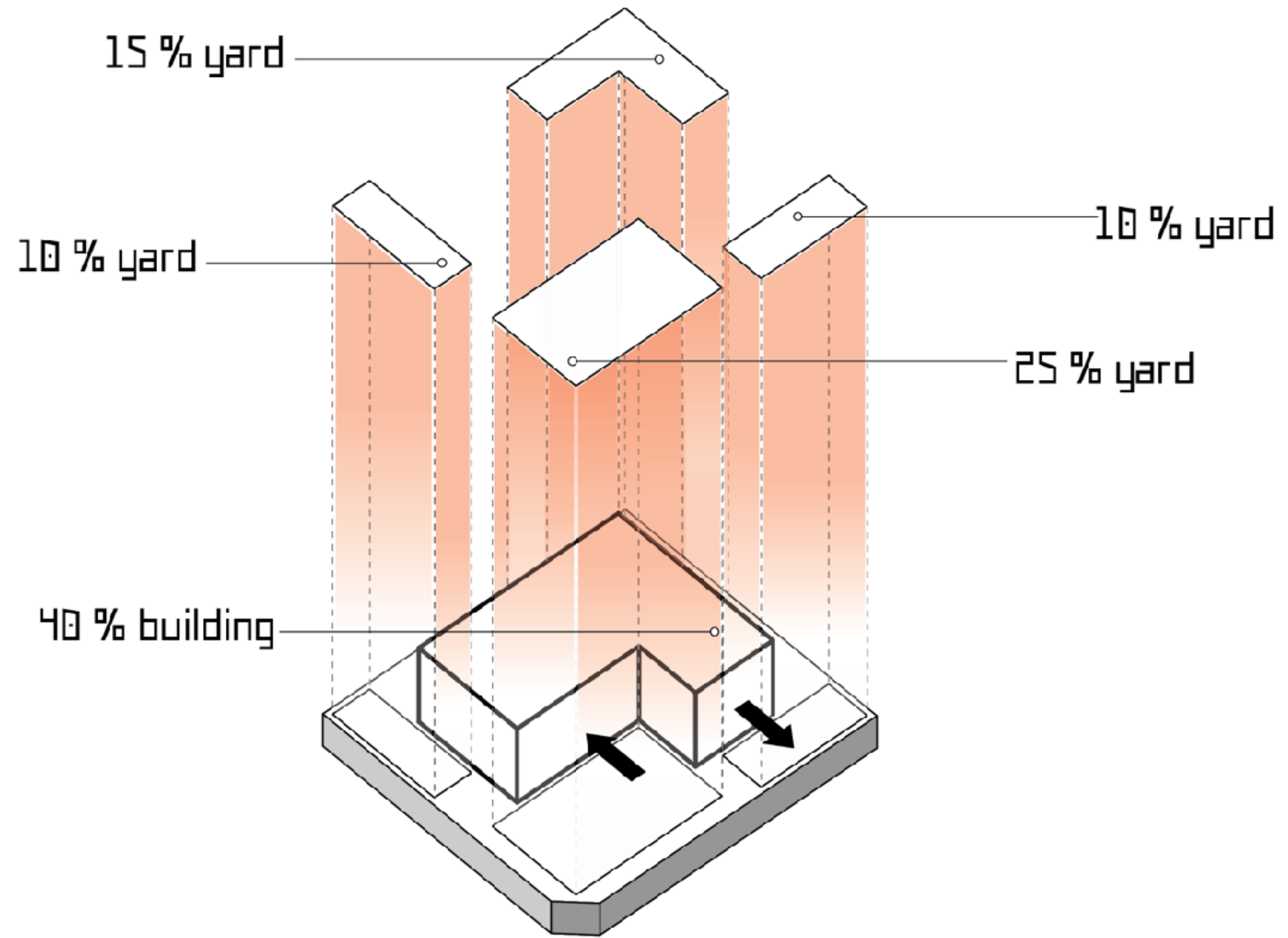

Initiating the process of creating a volumetric composition and forming private yards with more space

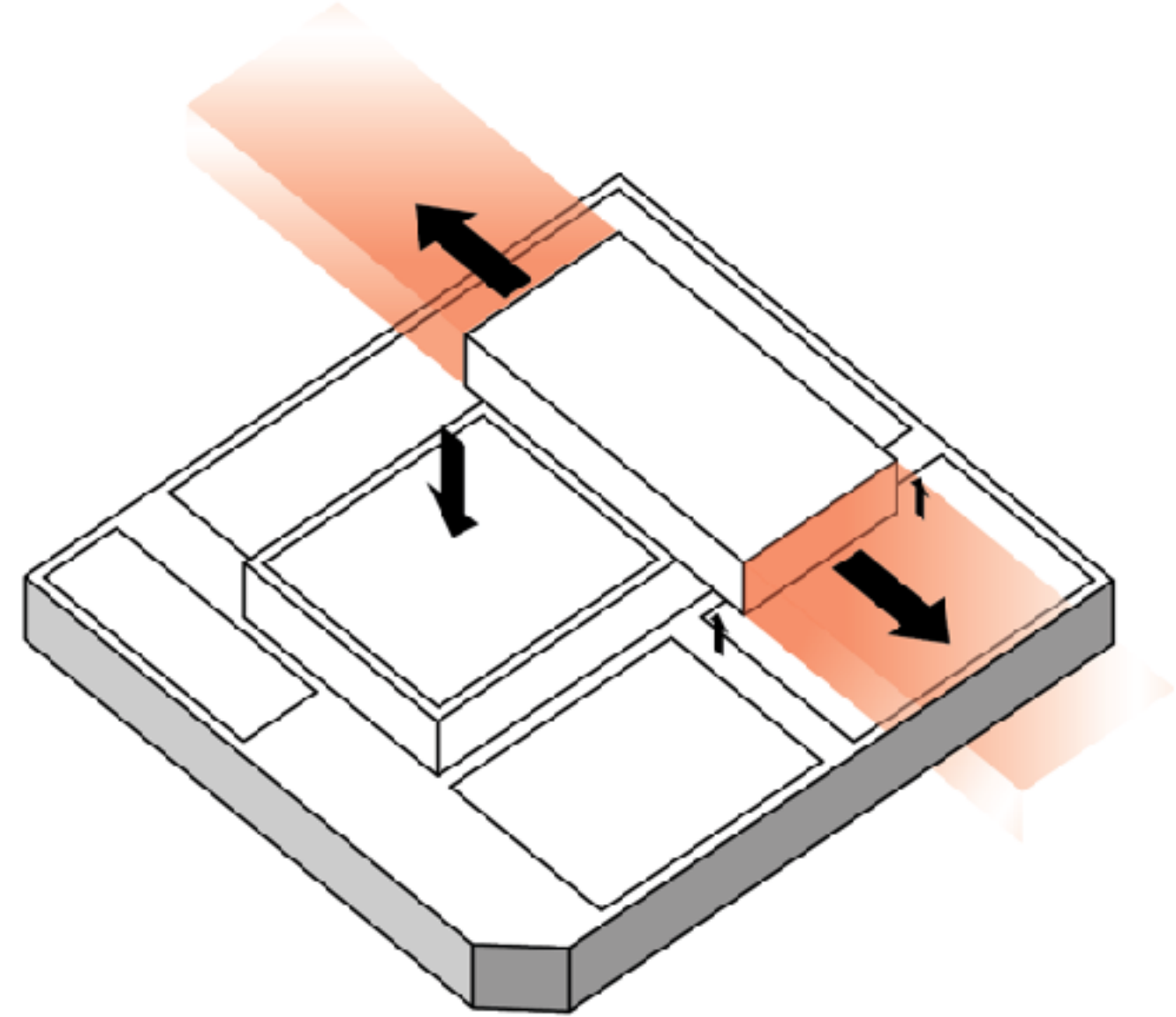

Rearranging volumes around to create
a volumetric composition of villas

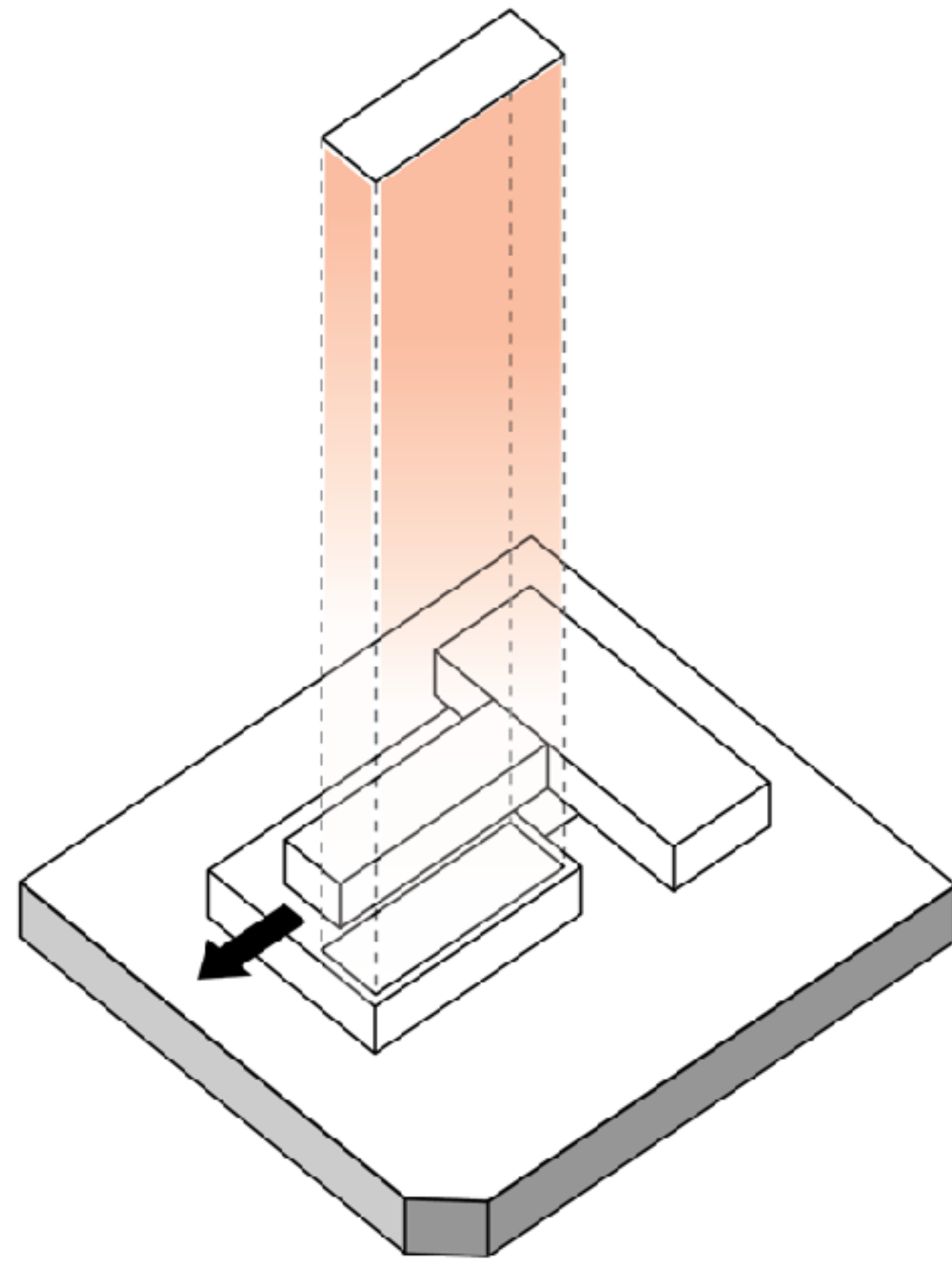

Moving cube-shaped volumes on top of each other to create villa terraces

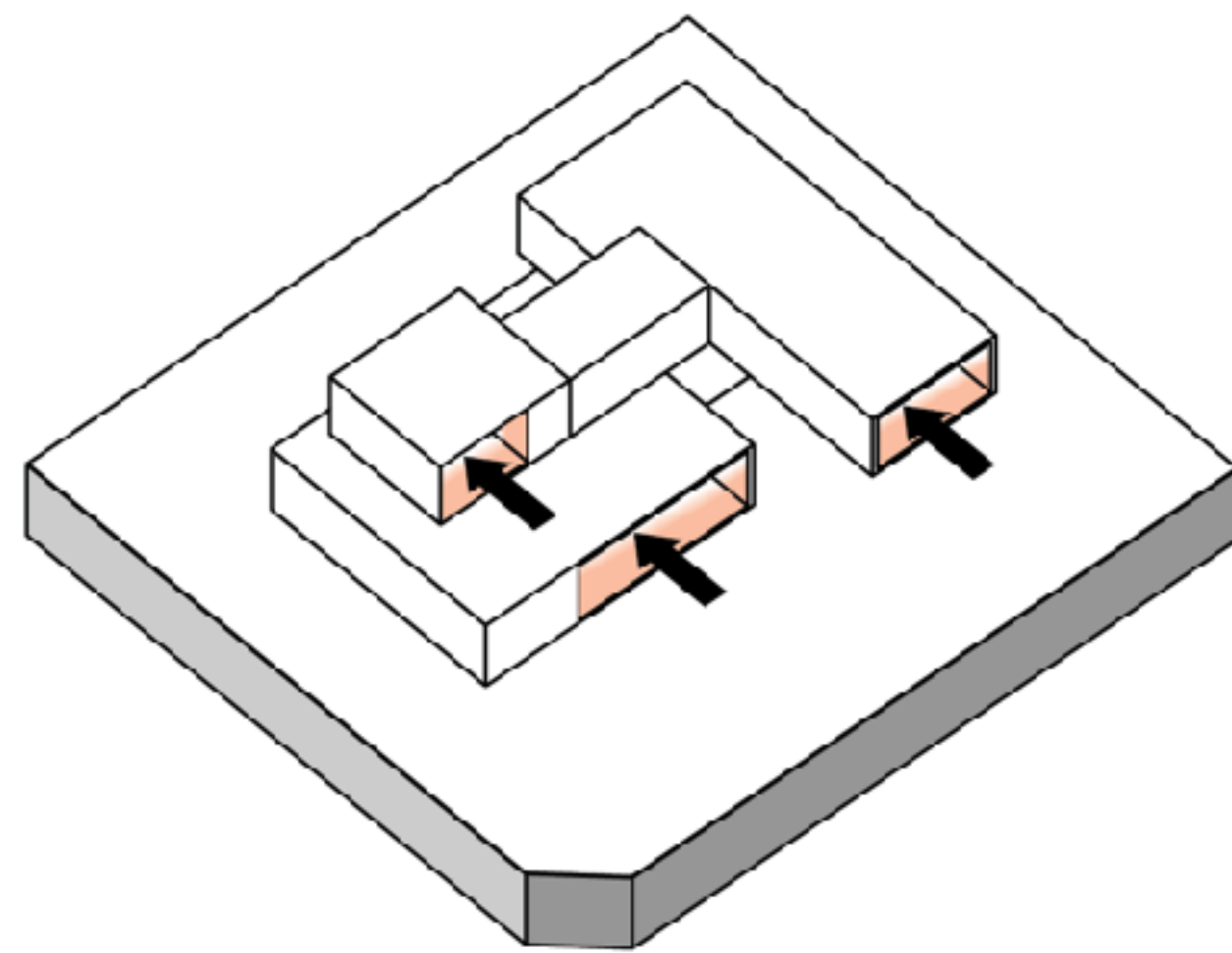

Moving the faces of cube-shaped volumes inward to create villa openings.

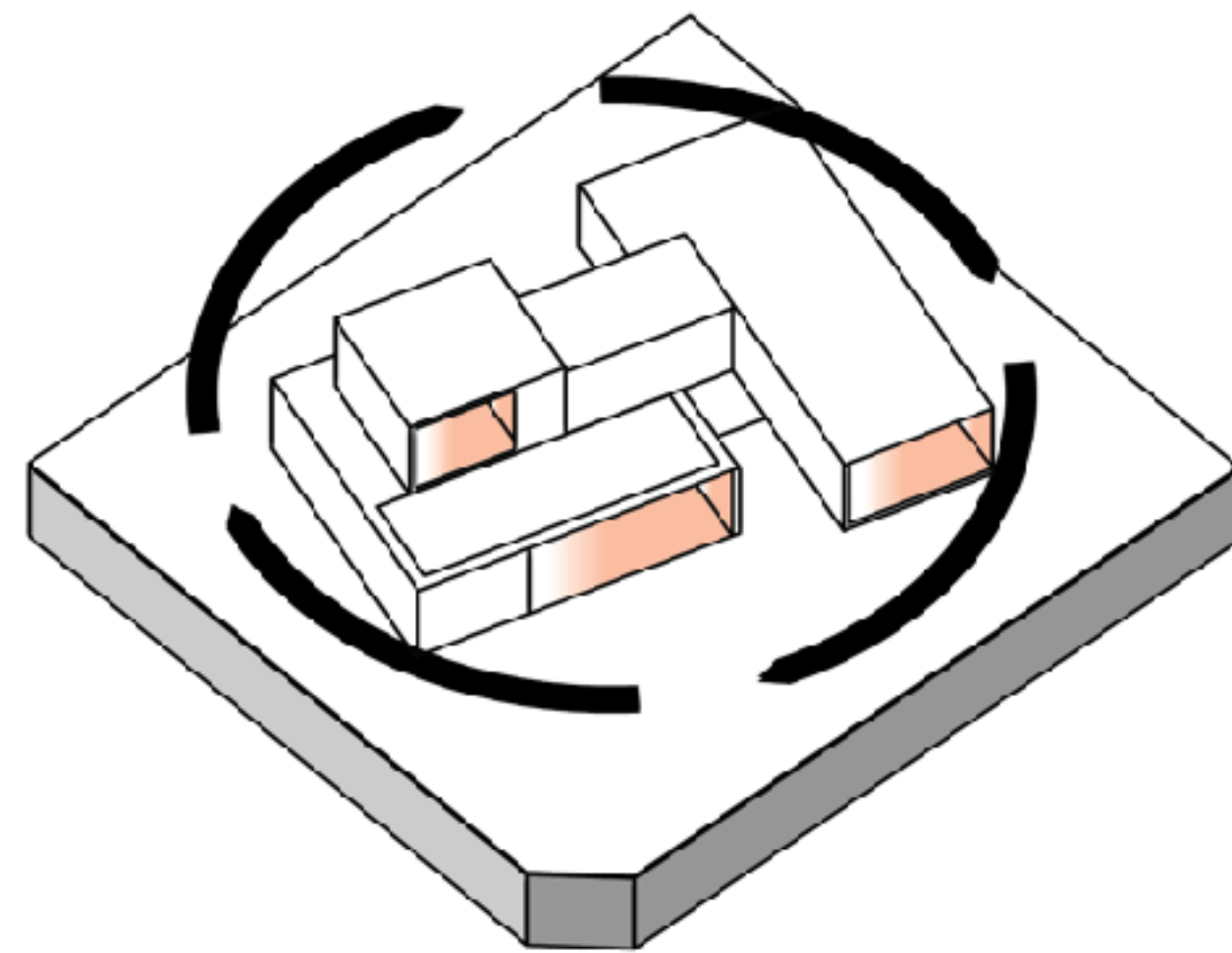

Rotating the entire volume of the villa by 15 degrees to optimize sunlight exposure and enhance the view

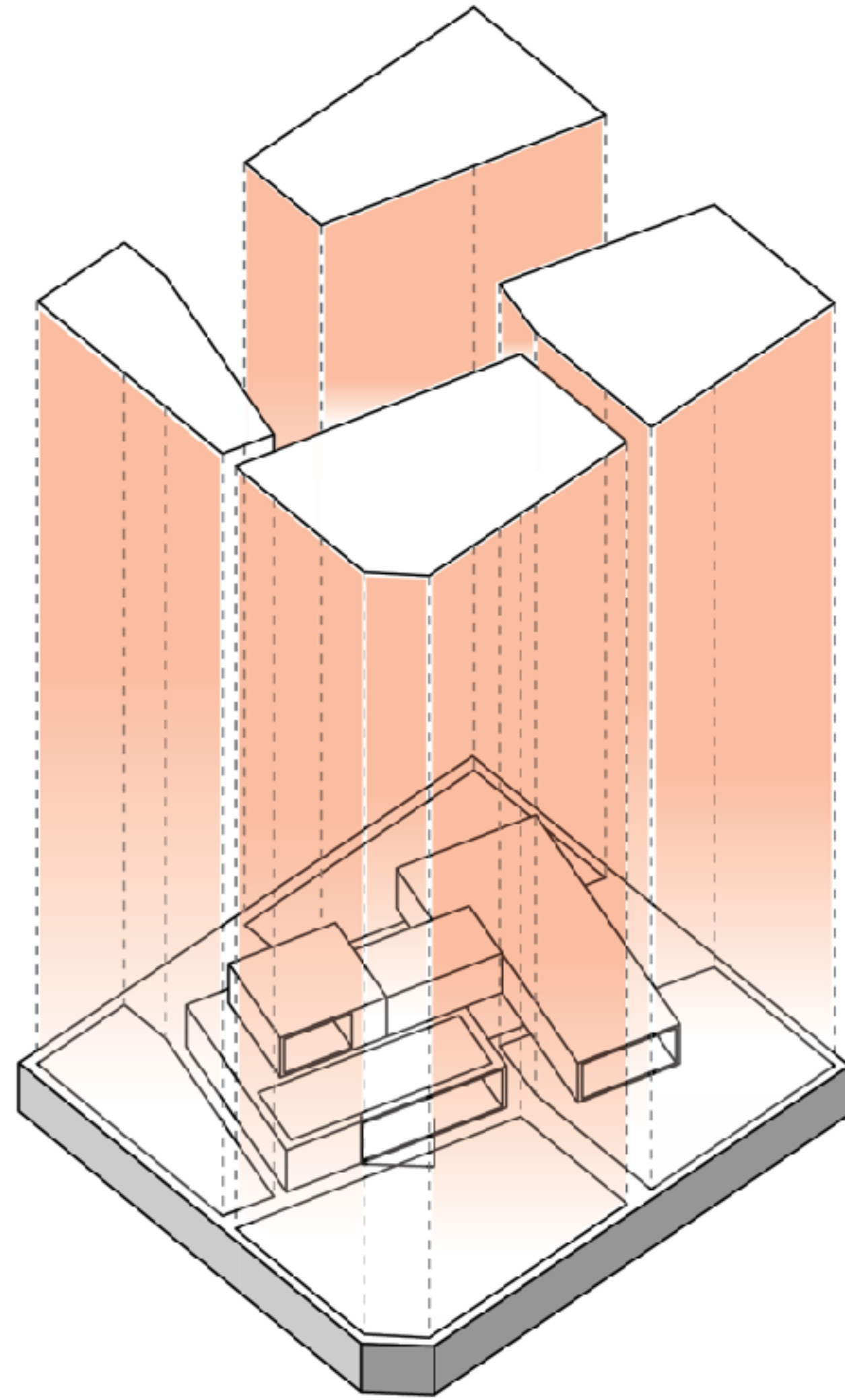

Changing the geometry of private yards by rotating the villa by 15 degrees

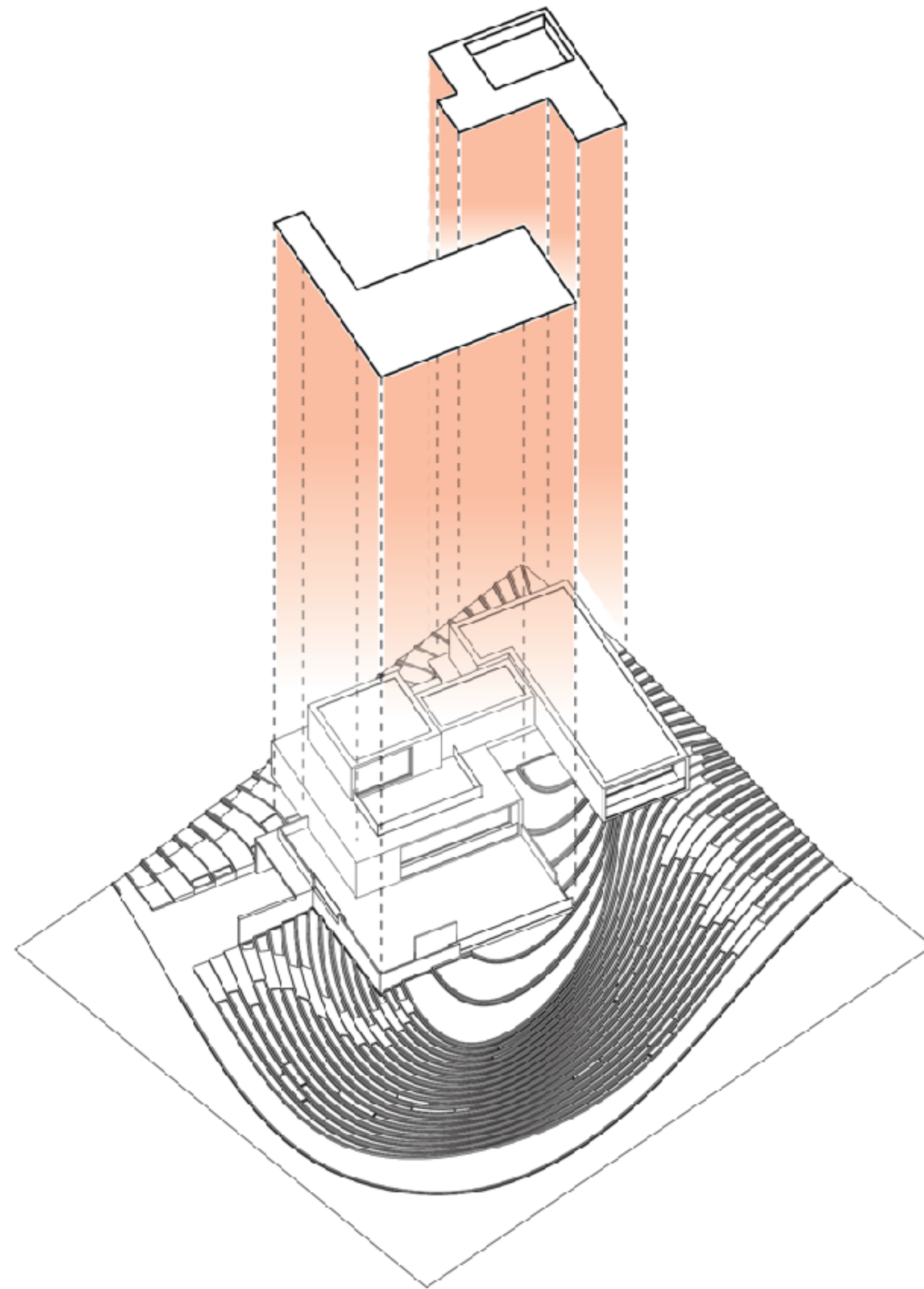

The overall geometry of the formed villa yards after being placed on the landscape site has been established